

N286Fe

900064-B

Four way ratchet mount. SS316

1" 14TPI male. Fits 1" 14TPI ferrule antennas.

N286Fe is a stainless steel four way ratchet mount for installation on any flat surface. The handle allows quick and easy antenna tilt when needed. N286Fe is equipped with a feed through hole for RG58C/U cable. Screw set is included. N286Fe has a smaller foot print than the similar mount N287Fe. This mount is manufactured in premium quality materials in order to prevent galvanic corrosion. The mount is always subject for improvement. The mount has the same rugged design as all other AC Antennas products thus it withstands harsh environmental conditions, both on Sea and Land.

Short description

Product group	Mount
---------------	-------

Mechanical specifications

Material	Stainless steel
Finish	SS316
Colour	SS316
Thread	1" 14TPI male / -
Rail/Mast Diameter [mm]	
Mounting	
Mounting method	1" 14TPI male. Fits 1" 14TPI ferrule antennas.
Weight [kg/lbs]	0.50 / 1.10
Size HxWxL [m]	0.08 x 0.09 x 0.14
Size HxWxL [ft]	0.26 x 0.30 x 0.50

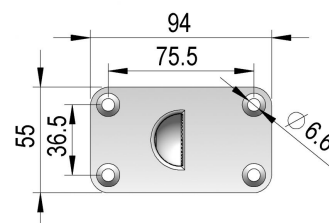
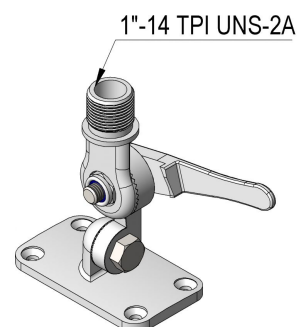
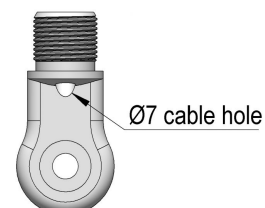

Handle readjust procedure

